

# STOCK LIST

## TUBING

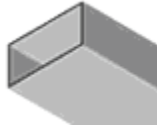

### RECTANGULAR

#### ALUMINUM

##### ALUMINUM RECT TUBING

W	L	WALL	WT/FT
1/2"	1"	.125	0.364
2"	1"	.125	0.810
3"	2"	.125	1.397
4"	2"	.125	1.673

#### CARBON STEEL

##### IMPORTED RECT TUBING 20' 40'

DIMENSIONS	WALL	L	WT/FT
3" X 1 1/2"	.120	24'	3.476
3" X 2"	3/16"	40'	5.590
3" X 2"	.250	20'	7.100
4" X 2"	3/16"	20'	6.870
4" X 2"	.120	20'	4.750
4" X 2"	1/4"	20'/40'	8.810
4" X 3"	.250	20'/40'	10.500
6" X 2"	3/16"	40'	9.420
6" X 2"	1/4"	40'	12.210

##### RECT. TUBING 20' 40'

W	L	WALL	WT/FT
1 1/2"	1"	.120	1.844
2"	1"	.065	1.269
2"	1"	.083	1.600
2"	1"	.120	2.252
2"	1 1/2"	.083	1.882
2"	1 1/2"	.120	2.660
2 1/2"	1 1/2"	3/16	4.320
2 1/2"	1 1/2"	1/4	5.410
3"	1"	.083	2.164
3"	1"	.120	3.068
3"	1 1/2"	.083	2.446
3"	1 1/2"	.083 RED OXIDE	2.446
3"	1 1/2"	.120	3.476
3"	1 1/2"	3/16	4.960
3"	2"	.083	2.728
3"	2"	.120	3.884
3"	2"	3/16	5.590
3"	2"	1/4	7.110
3 1/2"	2 1/2"	3/16	6.870
3 1/2"	2 1/2"	1/4	8.810
4"	2"	.083	3.290
4"	2"	.120	4.750
4"	2"	3/16	6.870

4"	2"	1/4	8.810
4"	3"	.120	5.610
4"	3"	3/16	8.150
4"	3"	1/4	10.510
4"	3"	3/8	14.710
5"	2"	1/4	10.510
5"	2"	3/16	8.150
5"	2"	5/16	12.700
5"	3"	.120	6.460
5"	3"	3/16	9.420
5"	3"	1/4	12.210
5"	3"	3/8	17.720
5"	4"	3/8	14.000
5"	4"	1/4	13.910
6"	2"	.120	6.460
6"	2"	3/16	9.420
6"	2"	1/4	12.210
6"	2"	5/16"	14.830
6"	3"	3/16	10.700
6"	3"	1/4	13.910
6"	3"	3/8	19.820
6"	3"	1/2	25.030
6"	3"	5/16	16.960
6"	4"	.120	8.160
6"	4"	3/16	11.970
6"	4"	1/4	15.620
6"	4"	3/8	22.370
6"	4"	1/2	28.430
7"	3"	3/16	11.970
7"	3"	3/8	22.370
7"	4"	1/4	17.320
7"	4"	3/8	24.930
7"	4"	1/2	29.680
7"	5"	1/4	19.020
7"	5"	3/8	27.480
7"	5"	1/2	35.240
8"	2"	3/16	11.970
8"	3"	3/16	13.250
8"	3"	1/4	17.320
8"	3"	3/8	13.250
8"	3"	5/16	21.210
8"	4"	3/16	14.530
8"	4"	1/4	19.020
8"	4"	3/8	27.480
8"	4"	1/2	35.240
8"	6"	3/16	17.080
8"	6"	1/4	22.420
8"	6"	3/8	32.580
8"	6"	1/2	42.050
10"	2"	3/16	14.530
10"	2"	1/4	19.020
10"	4"	1/4	22.420
10"	4"	3/8	32.580
10"	6"	1/4	25.820
10"	6"	3/8	37.690



# STOCK LIST

2.000	1.000	.500	8.010	4.250	4.010	.120	5.293
2.125	1.885	.120	2.570	4.250	3.500	.375	15.520
2.250	2.120	.065 ERW	1.517	4.250	3.250	.500	20.030
2.250	1.562	.344	7.002	4.500	3.500	.500	21.360
2.250	1.500	.375	7.509	4.500	3.000	.750	30.040
2.250	1.250	.500	9.345	4.750	4.000	.375	17.520
2.375	1.500	.438	9.061	4.750	2.750	1.000	40.050
2.375	1.937	.219	5.043	5.000	4.500	.250	12.680
2.375	2.000	.188	4.391	5.000	4.250	.375	18.520
2.375	2.245	.065 ERW	1.604	5.000	4.000	.500	24.030
2.500	2.370	.065 ERW	1.690	5.000	3.500	.750	34.040
2.500	2.334	.083	2.143	5.500	5.260	.120	6.895
2.500	2.260	.120	3.050	5.500	5.000	.250	14.020
2.500	2.260	.120 ERW	3.050	5.500	4.500	.500	26.700
2.500	2.187	.156	3.905	5.750	5.000	.375	21.530
2.500	2.125	.188	4.642	6.000	5.624	.188	11.670
2.500	2.000	.250	6.008	6.000	5.000	.500	29.370
2.500	1.875	.313	7.311	6.000	4.000	1.000	53.400
2.500	1.750	.375	8.511	6.500	5.250	.625	39.220
2.500	1.500	.500	10.680	6.500	5.500	.500	32.040
2.625	1.750	.438	10.230	7.000	4.500	1.25	76.760
2.625	1.625	.500	11.350	7.000	6.500	.250	18.020
2.750	2.250	.250	6.675	7.000	6.000	.500	34.710
2.750	2.000	.375	9.512	7.750	7.250	.250	20.030
3.000	2.834	.083	2.586	8.500	4.500	2.000	138.840
3.000	2.834	.083 ERW	2.586	10.000	6.000	2.000	170.880
3.000	2.760	.120	3.691	<u>GALVANIZED</u>			
3.000	2.688	.156	4.378	<u>GALVANIZED TUBING</u>			
3.000	2.250	.375	10.510	OD	GA	LENGTH	WT/FT
3.000	2.000	.500	13.350	1/2"	18	20'	0.236
3.000	2.500	.250	7.343	<u>HYDRAULIC</u>			
3.000	1.750	.625	15.850	<u>HYDRAULIC TUBING SEAMLESS 20'</u>			
3.000	1.500	.750	18.020	OD	WALL	WT/FT	
3.000	1.250	.875	19.860	3/16"	.028	0.048	
3.125	2.875	.125	3.851	3/16"	.035	0.057	
3.250	3.010	.120	4.011	1/4"	.035	0.080	
3.250	2.375	.438	13.150	5/16"	.035	0.104	
3.250	2.250	.500	14.690	3/8"	.035	0.127	
3.250	2.000	.625	17.520	1/2"	.035	0.174	
3.250	1.500	.875	22.190	1/2"	.049	0.236	
3.375	2.751	.313	10.240	1/2"	.065	0.302	
3.375	2.125	.625	18.360	1/2"	.095	0.411	
3.500	3.260	.120	4.332	5/8"	.049	0.301	
3.500	3.000	.250	8.678	3/4"	.049	0.367	
3.500	2.750	.375	12.520	3/4"	.095	0.665	
3.500	2.500	.500	16.020	1"	.049	0.498	
3.750	2.750	.500	17.360	1"	.095	0.920	
4.000	3.834	.083 ERW	24'3.472	<u>HYDRAULIC TUBING WELDED 20'</u>			
4.000	3.624	.188	7.654	DIAM	WALL	WT/FT	
4.000	3.500	.250	10.010				
4.000	3.000	.500	18.690				
4.000	2.750	.625	22.530				
4.000	2.250	.875	29.200				
4.000	2.000	1.000	32.040				
4.000	1.500	1.250	36.713				

# STOCK LIST

3/8"	.035	0.130
1/2"	.065	0.300
3/4"	.095	0.670

**STAINLESS**

STAINLESS RD TUBING SEAMLESS 20'

O D	ID	WALL	WT/FT
.188	.118	.035	0.057
.250	.180	.035	0.080
.313	.243	.035	0.104
.375	.305	.035	0.127

STAINLESS RD TUBING WELDED

OD	ID	WALL	L	WT/FT
0.375	0.305	.035	24'	0.127
1.250	1.010	.120	20'/24'	1.448
1.500	1.260	.120	20'	1.769
2.500	2.370	.065	20'	1.690

STAINLESS SANITARY TUBING 304L 20'

DIAM	WALL	WT/FT
1"	.065	0.649
1 1/2"	.065	0.996
2"	.065	1.343
2 1/2"	.065	1.690
3"	.065	2.037
4"	.083	3.472

**SQUARE**

ALUMINUM

ALUMINUM SQ TUBING 21'

DIAM	WALL	WT/FT
1/2"	.063	0.196
3/4"	.125	0.368
1"	.125	0.516
1 1/4"	.125	0.676
1 1/2"	.125	0.810
1 3/4"	.125	0.956
2"	.125	1.103
2"	.250	2.058
3"	.125	1.691

CARBON STEEL

IMPORTED SQUARE TUBING

DIAM	WALL	LENGTH	WT/FT
1"	.083	20'/24'	1.035
1"	.120	20'	1.436
1 1/4"	.083	20'	1.317
1 1/4"	.120	20'	1.844

1 1/2"	.065	20' 24'	1.269
1 1/2"	.083	20'	1.600
1 1/2"	.120	20'	2.252
2"	.120	20'/24'/40'	3.068
2"	3/16"	20/40'	4.320
2"	1/4"	20/40'	5.410
3"	.120	20'	4.750
3"	.083	20'	3.290
3"	3/16"	20/40'	6.870
3"	1/4"	20/40'	8.810
3 1/2"	1/4"	20'/40'	8.678
3 1/2"	3/16"	20'/40'	6.650
4"	1/4"	20/40'	12.210
4"	.120	20'	6.460
4"	3/16"	20'/40'	7.654

SQUARE TUBING

W	WALL	LENGTH	WT/FT
1/2"	.065	20'/24'	0.385
3/4"	.065	20'/24'	0.606
3/4"	0.83	20'	0.753
1"	.065	20'/24'	0.827
1"	.083	20'	1.035
1"	.120	20'/24'	1.436
1"	3/16	21'/24'	1.760
1 1/4"	.065	24'	0.75
1 1/4"	.083	20'	1.317
1 1/4"	.109	20'/24'	1.691
1 1/4"	.120	20'/24'/3' 8 7/8"	1.844
1 1/4"	3/16	20'	2.407
1 1/2"	.065	20'	1.269
1 1/2"	.083	20'/24'/30' 6"	1.600
1 1/2"	.120	20'/14' 1/4"	2.252
1 1/2"	3/16	20'	3.040
1 1/2" MEX	3/16"	20'	3.040
1 1/2"	1/4	20'	4.070
1 3/4"	.083	24'	1.881
1 3/4"	.120	24'	2.660
2"	.065	24'	1.710
2"	.083	20'	2.164
2" RED OXIDE	.083	24'	2.164
2"	.120	20'/24'/8' 5 1/2'/6' 8"	3.068
2"	3/16	20/40'	4.320
2"	1/4	20/40'	5.410
2 1/2"	.083	20'/24'	2.730
2 1/2"	.120	20'	3.884
2 1/2"	.134	20'/20' 4'/34' 7"	4.312
2 1/2"	3/16"	20/40'	5.590
2 1/2"	1/4"	20/40'/7' 9 3/4"	7.110
2 1/2" FL. CONT	1/4"	20'	7.110
3" RED OXIDE	.083	20'/24'	3.290
3"	.083	20'	3.290
3"	.120	20/40'	4.750
3"	.134	20'/24'/40'	5.110
3"	3/16"	20/40'	6.870

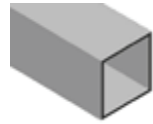

# STOCK LIST

3"	¼"	20'40'	8.810
3"	5/16"	20'40'	10.580
3"	3/8"	20'40'/7' 9 ¾"	12.170
3 ½"	.120	20'40'	5.610
3 ½"	3/16"	20'40'	8.150
3 ½"	¼"	20'40'	10.510
3 ½"	5/16"	40'	12.700
3 ½"	3/8"	20'40'	14.710
4" RED OXIDE	.083	24'	3.850
4"	.120	20'24'40'	6.460
4"	3/16"	20'24'40'	9.420
4"	6	20'40'	10.010
	gauge		
4"	¼"	20'40'42'	12.210
4" HSLA-70	¼"	48'	12.210
4"	5/16"	20'40'	14.830
4"	3/8"	20'40'/7'8"/7'9 ¾"	17.270
4"	½"	20'40'	21.630
4½"	3/16"	40'	10.700
5"	3/16"	20'40'	11.970
5"	¼"	20'40'	15.620
5"	3/8"	20'40'	22.370
5"	½"	20'40'	28.430
6"	3/16"	20'40'	14.530
6" HSLA 70	3/16"	20'40'	14.530
6"	¼"	20'40'	19.020
6"	5/16"	40'48'	23.340
6"	3/8"	20'40'	27.480
6"	½"	20'40'	35.240
7"	¼"	20'40'	22.420
7"	5/16"	40'	27.590
7"	3/8"	20'40'	32.580
7"	½"	40'	42.050
8"	3/16"	40'	19.630
8"	¼"	20'40'	25.820
8"	3/8"	20'40'	37.690
10"	¼"	20'40'	32.630
10"	3/8"	40'	47.900

## STAINLESS

### STAINLESS SQ TUBING 20'

DIAM	WALL	WT/FT
1"	.065	0.827
½"	.065	0.385
1"	.120	1.436
1 ¼"	.083	1.317
1 ¼"	.120	1.844
1 ½"	.083	1.599
1 ½"	.120	2.252
2"	.120	3.050
2"	¼"	5.410
3"	3/6"	6.578
3"	¼"	8.810
4"	¼"	12.210

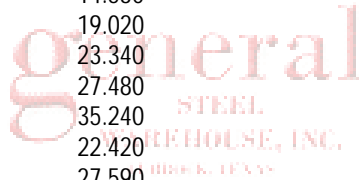

## GALVANIZED

### GALVANIZED PERF. TELESCOPIC TUBING

DIAM	WALL	L	WT/FT
1 ¾"	.105	24' 2"	2.060
2"	.105	24' 2"	2.416
2 ¼"	.105	24' 2"	2.773

### GALVANIZED SQUARE TUBING 20'

WIDTH	WALL	WT/FT
1"	.049	0.634
1"	.065	0.827
1 ½"	.120	2.410
2"	3/16	4.810
4"	¼"	13.180